

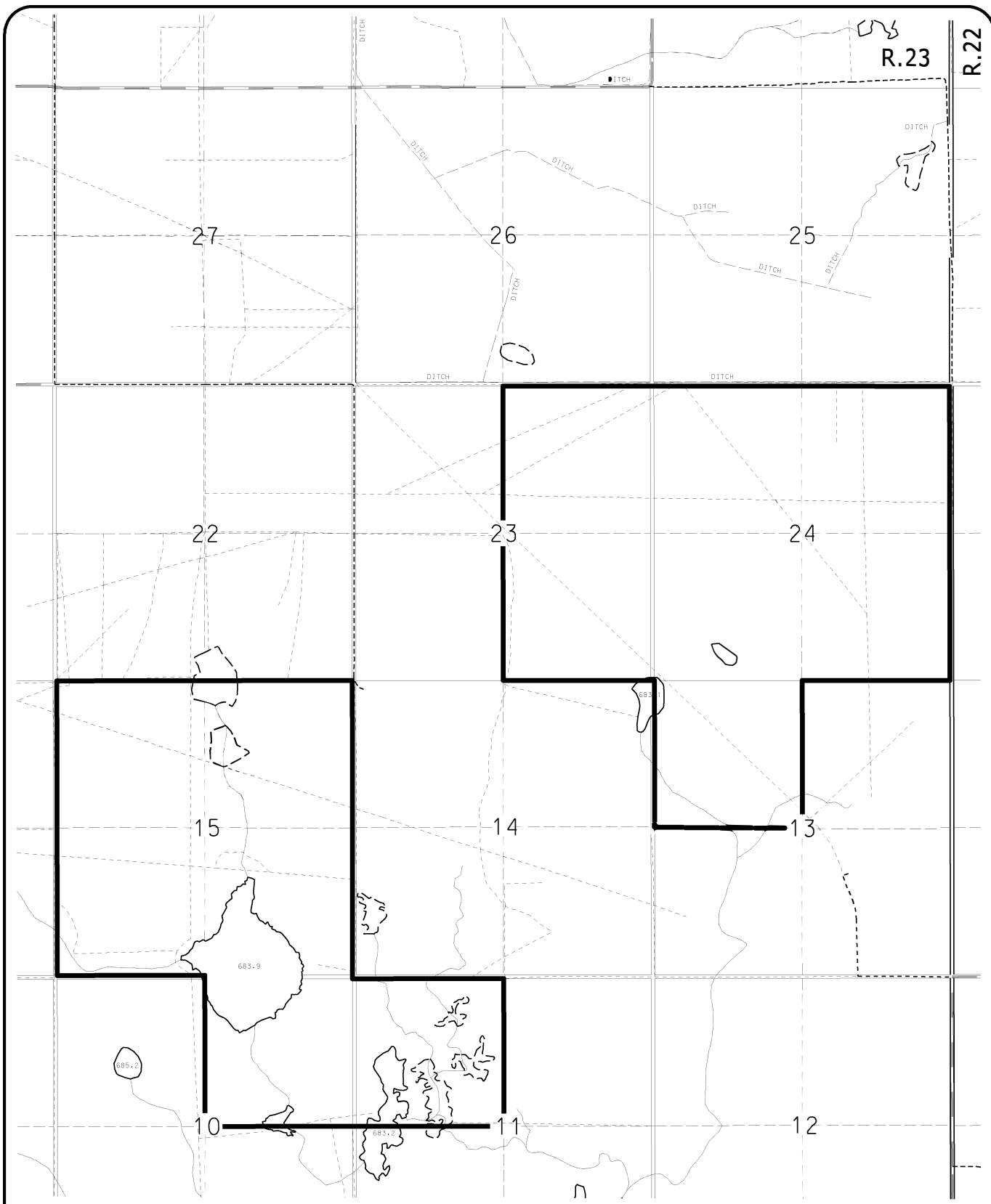

R.23

R.22



Area 2,094.79 Ac. <small>Source: GIS 10TM, NAD 83</small> 847.731 Ha	DEPARTMENT OF COMMUNITY DEVELOPMENT Parks and Protected Areas Division PLAN SHOWING TAWATINAW NATURAL AREA IN TOWNSHIP 61, RANGE 23 WEST OF THE FOURTH MERIDIAN	Scale 1:30 000
D.C. Number 416/98-41		Date map produced JAN. 07, 2002
Graphic File TAWATINAW		Drawn by LAC
Remarks text edited WAP Feb 2026	NATURAL AREA BOUNDARY SHOWN THUS 	Digital data: 1:20 000 83i06sw Supplied by Resource Data Division, 1998 NAD 83

SCHEDULE 41

TAWATINAW NATURAL AREA

In Township 61, Range 23 West of the 4th Meridian.

FIRSTLY

The north west quarter of section 11
The north west quarter of section 13
The north half of section 15
The east half of section 23
Section 24

SECONDLY

All that portion of the north east quarter of section 10 and the south half of section 15 which is not covered by any of the waters of Lake No. 1.

All that portion of the north east quarter of section 10, the south half of section 15 and the statutory road allowance between sections 10 and 15 which comprises of the bed and shore of Lake No. 1.

As shown upon a map or plan of survey of the said township approved and confirmed at Ottawa on the 11th day of August, 1909 by E. Deville, Surveyor General of Dominion Lands, and on file in the Department of Environmental Protection at Edmonton.