

**CALLING**

593.0

**LAKE**

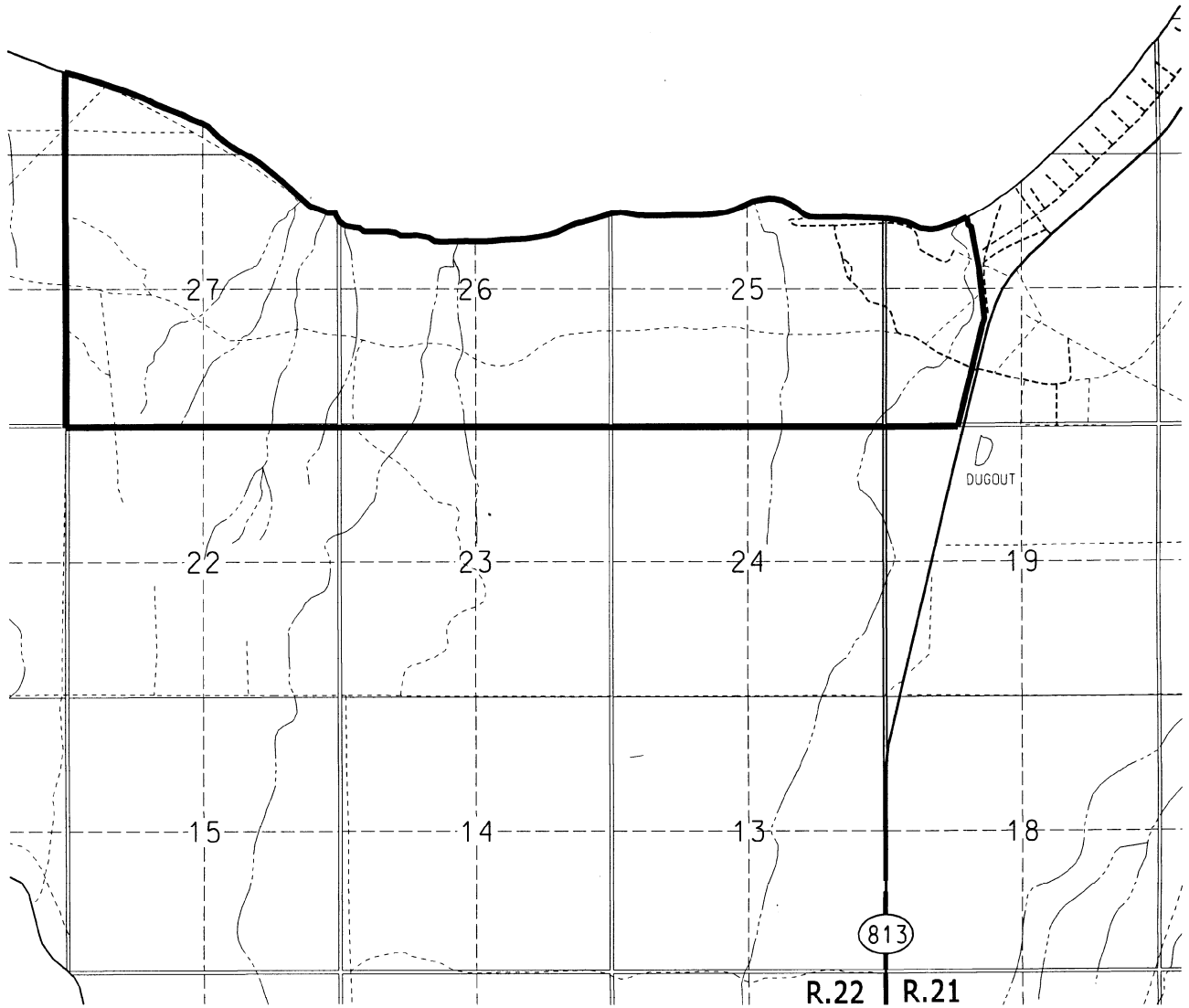

Area 1,824.37 Ac. 738.32 Ha	<b>DEPARTMENT OF ENVIRONMENT</b> <b>Parks and Protected Areas Division</b>	Scale 1:40 000
O.C. Number 623/91		Date FEB. 22, 2000
Graphic File CALLING LAKE	PLAN SHOWING <b>CALLING LAKE</b> PROVINCIAL PARK IN TOWNSHIP 71, RANGES 21-22 WEST OF THE FOURTH MERIDIAN	Drawn by LAC
Remarks 83p03nw 83p03ne	PARK BOUNDARY SHOWN THUS <b>————</b>	Digital data: 1:20 000 Supplied by Resource Data Division, 1998 NAD 27

## CALLING LAKE PROVINCIAL PARK

### FIRSTLY:

All that parcel or tract of land, situate, lying and being in the seventy-first (71) township, in the twenty-first (21) range, west of the fourth (4) meridian, in the Province of Alberta, Canada, and being composed of:

All that portion of the west half of section thirty (30) of the said township, not covered by any of the waters of Calling Lake, lying to the north and west of the northwesterly limit of a surveyed roadway, as shown upon a plan of survey of record in the Land Titles Office at Edmonton for the North Alberta Land Registration District as No. 832 2115 and to the south and west of the southwesterly limit of Calling Lake subdivision, as shown upon a plan of survey of record in the said Land Titles Office as No. 641 N.Y., containing sixty-four and fifty-two thousandths (64.052) hectares (158.27 acres), more or less.

### SECONDLY:

All those parcels or tracts of land, situate, lying and being in the seventy-first (71) township, in the twenty-second (22) range, west of the fourth (4) meridian, in the Province of Alberta, Canada, and being composed of:

The south halves of sections twenty-five (25) and twenty-six (26), the south half and north west quarter of section twenty-seven (27) and all those portions of the north halves of the said sections twenty-five (25) and twenty-six (26), the north east quarter of the said section twenty-seven (27) and the south half of section thirty-four (34) of the said township, not covered by any of the waters of the said Lake, containing six hundred seventy-four and two hundred seventy-one thousandths (674.271) hectares (1,666.10 acres), more or less.

The lands herein described contain seven hundred thirty-eight and three hundred twenty-three thousandths (738.323) hectares (1,824.37 acres), more or less.